

COMPANY CATALOGUE

2024



YOUR
PARTNER
FOR FUTURE
INTRALOGISTICS NEEDS

UPRIGHT STORAGE SOLUTIONS, PH INC.

Birmingham Barangay Pulo, City
of Cabuyao Laguna, Philippines , 4025



Contact us at
(049)537-9537 , 0917-307-4238
0917-115-9581 , 0960-911-1879



Mail us at
urssphi@gmail.com



Chat with us at
www.uprightstoragesolutions.com

About Us

Company Introduction

Intralogistics Built for The Future

With the rapid growth of e-commerce and warehouse technologies, new opportunities and challenges abound in the intralogistics sector. From increasing inventories to complex material handling and storage needs, we, **UPRIGHT Storage Solutions, PH Inc. (URSSPI)** is committed to deliver innovative solutions for greater efficiency and reliability in our clients' overall supply chain and logistics.

Your Industrial Storage and Racking Solutions Provider

UPRIGHT Storage Solutions, PH Inc. (URSSPI) is a leader in storage and shelving solutions, serving a broad range of clients in residential, commercial, and industrial sectors worldwide. Initially a company manufacturing racking and shelving products, URSSPI has grown to become a space-optimising solutions provider.

Driven to High Standards and Quality

Behind our impeccable services and products stands a unique combination of advanced manufacturing facilities and technical expertise. Complementing our diverse product portfolio, we only use certified steel materials and qualified workmanship to provide solutions that meet quality and safety standards.





Vision

We aim to be your ultimate partner for racking and shelving storage solutions and become preferred intralogistics solutions provider. To this end, we continuously level up the “UPRIGHT” brand to comply with international standards and quality, ensuring the peace of mind of our clients.



Missions

Our missions are:

- 01** To design, innovate and deliver high-quality pallet racking and shelving systems that meet international standards and the needs of various customers.
- 02** To remain committed, continuously improve and exceed the expectations of our clients.
- 03** To maximize storage space and enhance intralogistics efficiency by leveraging on our industry knowledge and experience.

Core Values

Uniting our people and purpose.

At the heart of our organization, our core values and company vision dictate our business direction and shape our culture. Our principles are a fundamental part of Upright's team and day-to-day operations, allowing us to make ethical decisions and fulfil our responsibility to our clients and business partners.

Customer First

With experience globally and locally, we understand customers' needs, providing tailored solutions and products to enhance their intralogistics performance.

Quality Excellence

Our products are built with quality in mind, complying with British, EURO and FEM Standards. We ensure strict quality control and assurance with testing in the laboratory.

Long-Term Thinking

We strive to lay a solid foundation with our customers and grow together with them as their business grows.

Integrity

We believe that honesty and integrity are integral to a business's success. Thus, we uphold industry best practices and abide by all applicable laws and regulations.

15 Years

of industry Experience

FEM & EN

DESIGN STANDARD
COMPLIANCE

10 Years

Product Warranty

2 Years

FREE Preventive
Maintenance

**Racking
Safety Seminar**

With Certificate for FREE

STEEL STORAGE RACKING
AS 4084-2012

COMPLIANT

Services

Tailor-made services for you.

Through all stages of your project, we provide comprehensive services to meet unique client requirements and specifications. We ensure that you make the most of your investment, from flexible solutions to on-site support and maintenance.

Free On-Site Consultation by our Sales Team



Free Design and Solution Proposal

Installation Service and Dismantling of Racking System



Scheduled Racking Maintenance Programme



WHAT IS **PALLET RACKING**?

In any developing country/society, the issue of land scarcity or the challenges of maximizing one's space utilization is very common to hear off. As such the common and budget worthy solution for one to consider is the using of Storage Equipment, e.g. Pallet Racking.

Pallet Racking is a material handling storage aid system designed to store palletized or loose items. It is available in various varieties in order to suite for all types of storage needs. The usage of Pallet Racking has allowed for the storage of palletized materials in horizontal rows with multiple levels and with the main aimed increasing ones storage density.

To create the ideal pallet racking system, several considerations should be taken into account:

- Desired storage density
- Floor space and building height
- Placement of building doors and columns
- Inventory accessibility
- Inventory rotation
- Item/load size and weight
- Optimal storage design
- Cost of materials and installation

BEFORE INSTALL PALLET RACKING:



AFTER INSTALL PALLET RACKING:

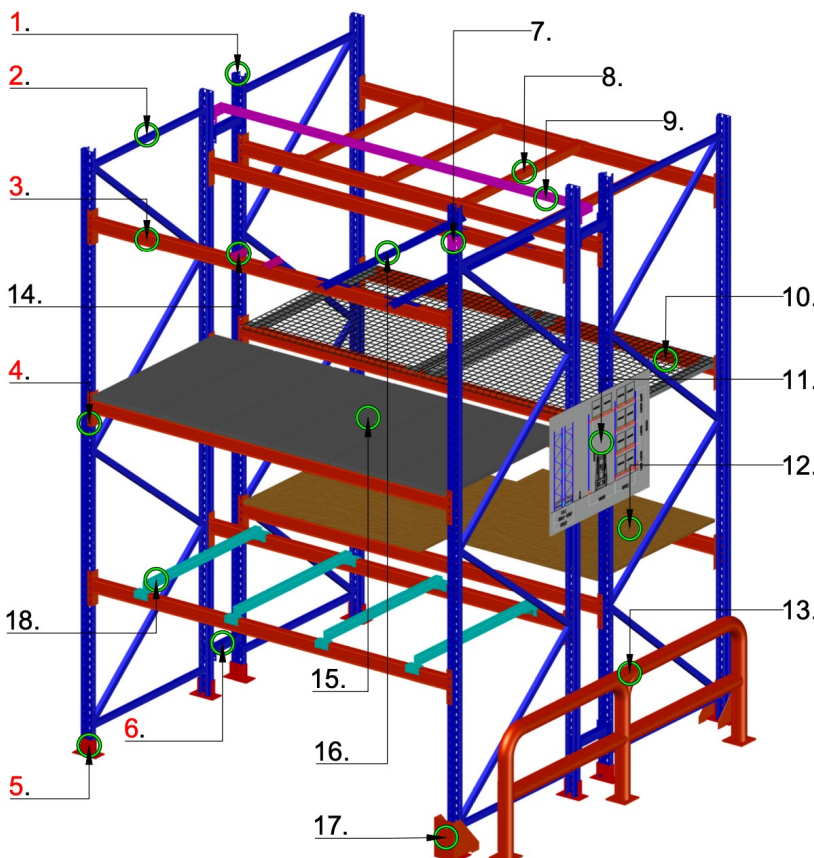

"DESCRIPTION"

BASIC PALLET RACKING COMPONENTS:

1. UPRIGHT POST
2. BRACING
3. BOX BEAM
4. SAFETY PIN
5. BASEPLATE
6. ROW SPACER

ACCESSORIES:

7. SPLICE
8. PALLET SUPPORT BAR (PSB)
9. PALLET BACK STOPPER
10. WIRE MESH DECKING
11. SAFETY WORKING LOAD SIGNAGE
12. CHIP BOARD / PLYWOOD
13. SAFETY BARRIER
14. DRUM CHOCK
15. GALVANIZED STEEL SHELF PANEL
16. COIL HOLDER
17. COLUMN GUARD
18. FORK SPACER

**SAFETY
LOCK PIN**

**BOX
BEAM**

UPRIGHT

**HEAVY DUTY
BASE PLATE**

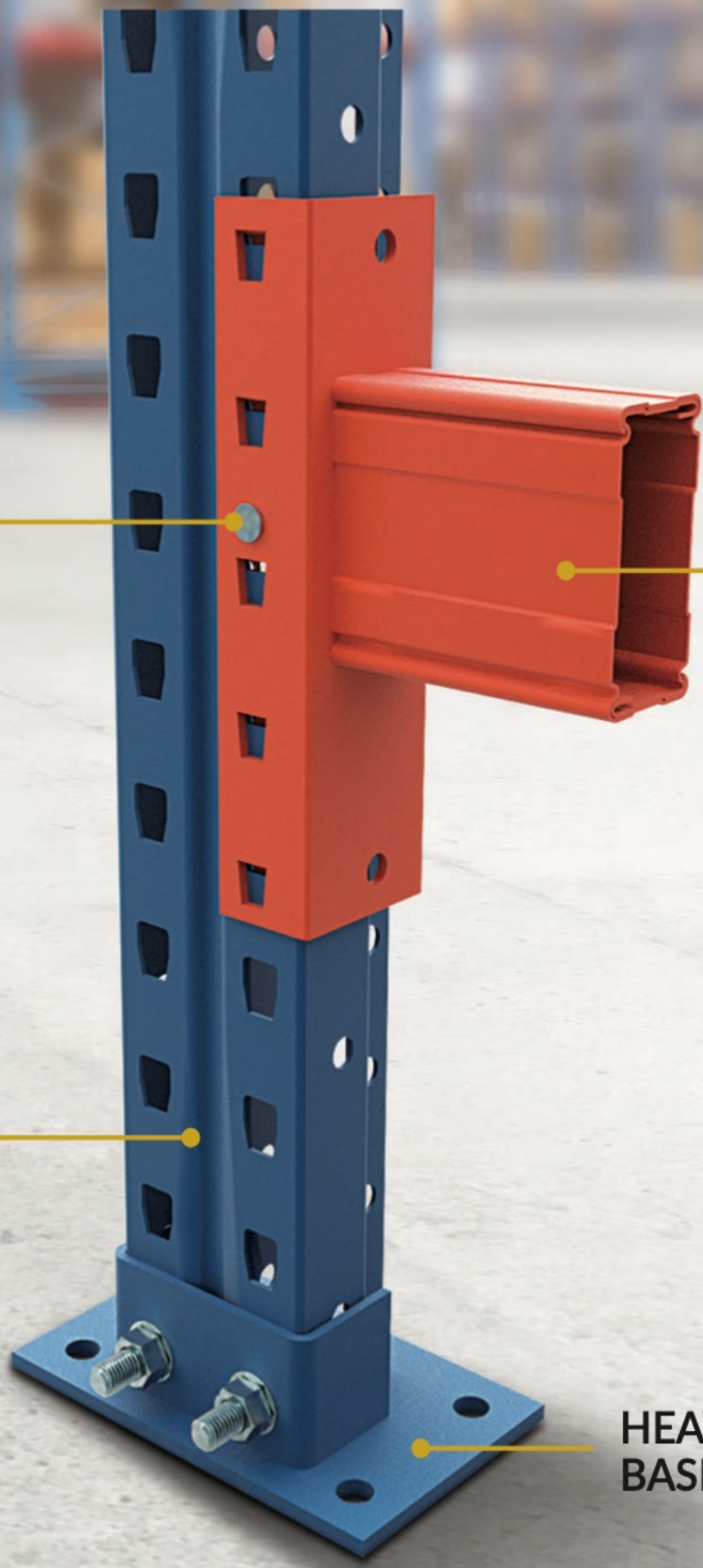

UPRIGHT I. For Heavy Duty Racking System

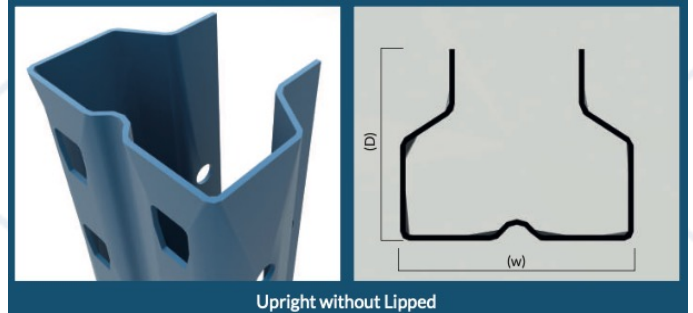
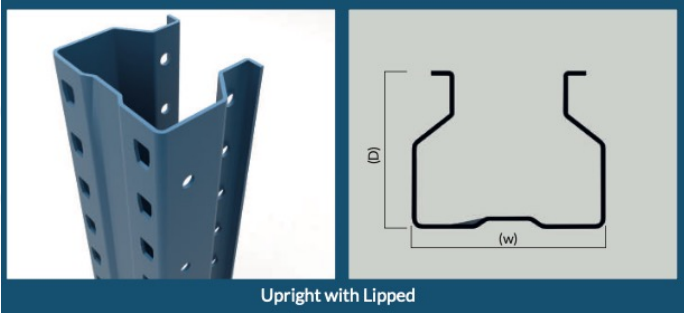

UPRIGHT ii. For Medium Duty System

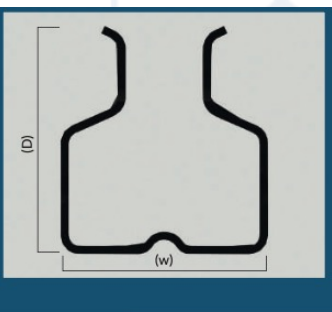
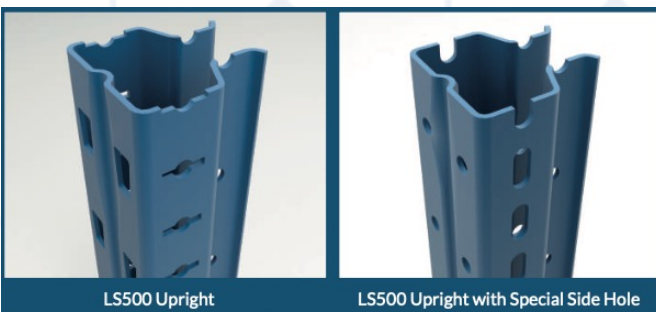

BASEPLATE

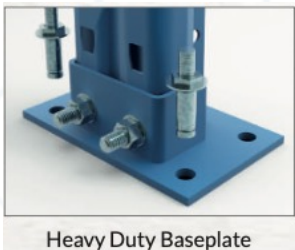

BEAM

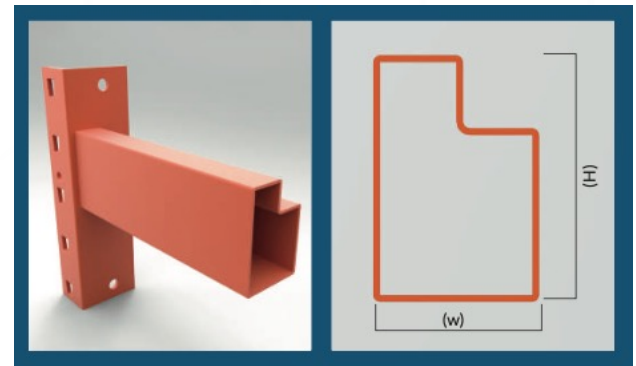
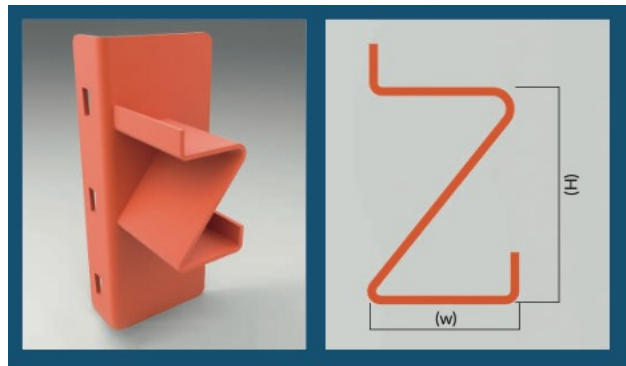
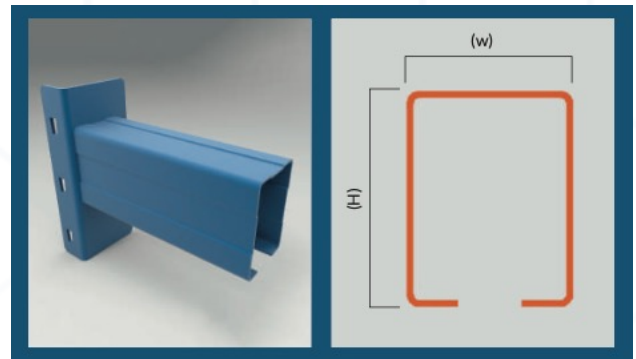
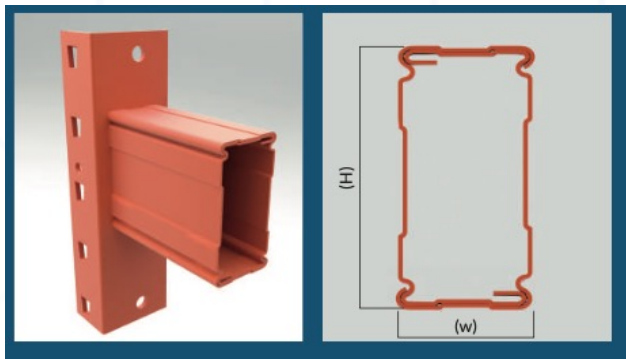

TYPE OF INDUSTRIAL RACKING SOLUTIONS



Selective Pallet Racking System



Double Deep Racking System



Shuttle Racking System



Automated Storage & Retrieval (AS/RS) System

TYPE OF CARTON STORAGE SOLUTIONS



Multi-tier Racking System

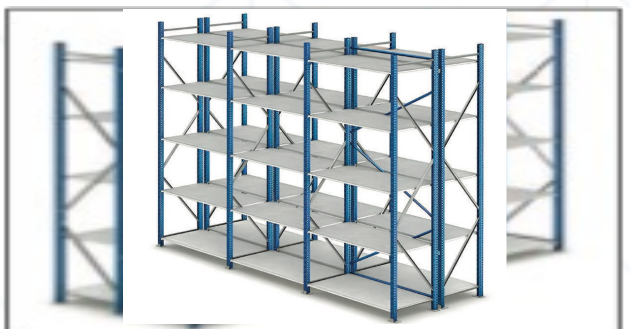

Longspan Shelving System

TYPE OF SPECIFIC STORAGE SOLUTIONS



Structural Steel Platform

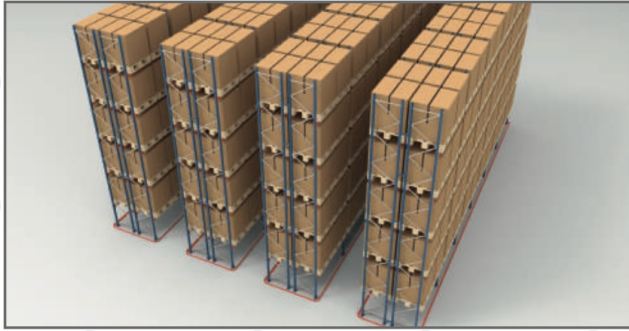

Very Narrow Aisle (VNA) Racking System



Drive-In Racking System



Pallet Flow System



Cart Push Back

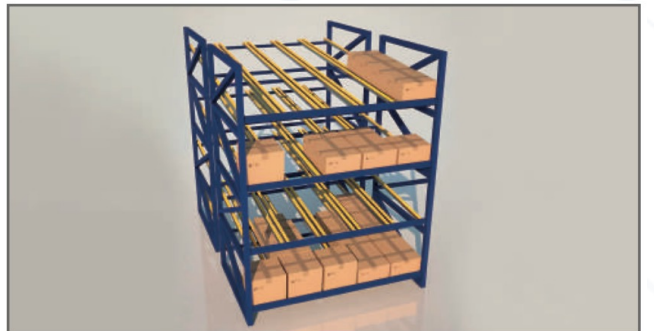

Cantilever Racking System

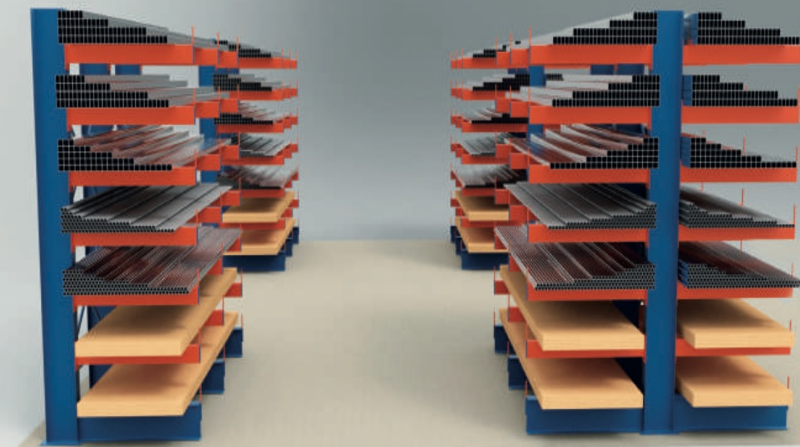

SELECTIVE PALLET RACKING SYSTEM

This is the most commonly used racking system for storing multiple locations and 100% selectivity. This system offers the most economical, efficient storing and retrieval of pallets. It is believed that this is the most cost-effective and adaptable storage solutions for one to start with.

FEATURES:

- The most commonly used for storing palletized unit loads.
- Stores full pallets in single deep rows and up multiple levels.
- Support First In First Out (FIFO) operation using single aisle access
- for storage and retrieval of pallets.
- Each pallet can be access individually.

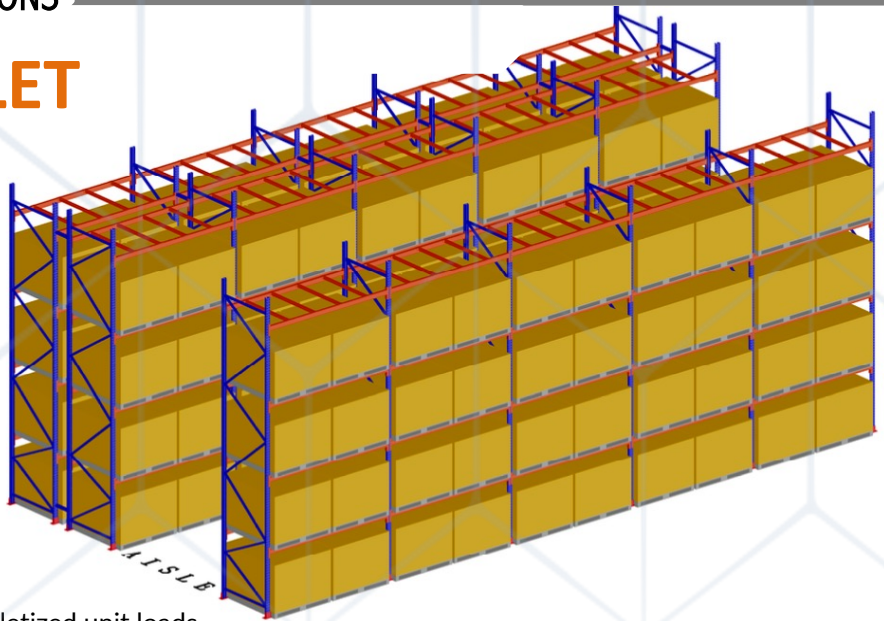

ADVANTAGES:

- 100% accessibility to each pallet.
- High visibility on stored goods.
- Similar pallet types are unnecessary.

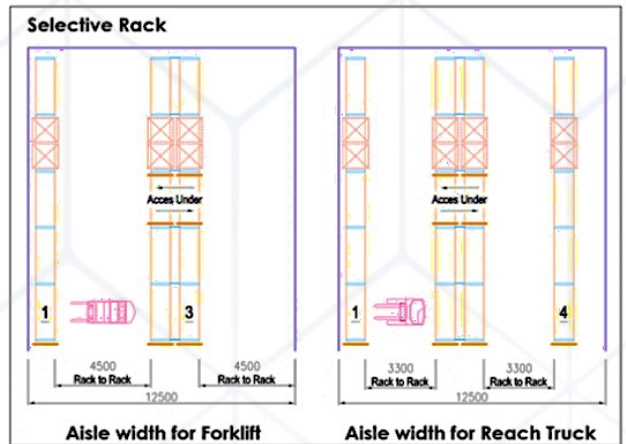

DOUBLE DEEP RACKING SYSTEM



Double Deep Pallet Racking is designed to store 2 pallets deep, which consist of two standard Selective Racks set up back to back. This system has to be used with double deep reach truck with deal pantograph or extension fork attachment.

The advantages of Double Deep Racking System

- Increase storage density and capacity up to 30% more than
- Suitable for Last in First Out (LIFO)
- Convertible from SELECTIVE
- Do not required a large number of homogeneous

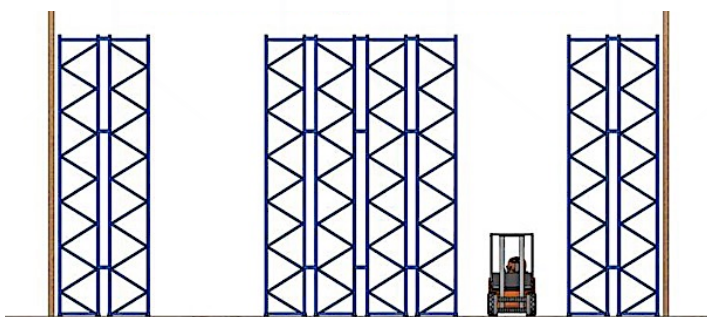

Although with increased storage capacity, but only 50% of pallets can be immediately accessible. Therefore Double Deep is only recommended for operations that require less critical picking and storing speed.

VERY NARROW AISLE (VNA) RACKING SYSTEM

Very Narrow Aisle (VNA) Racking System is designed to provide high-density storage with 100% selectivity. The design of VNA Racking System allows pallets to be stored with high density volume. The pallets can be accessed with Turret Truck (VNA truck), operate on floor guided by rails or wire induction and it can lift pallets up to 14 meter high. Save up to 50% more space than standard reach truck.

FEATURES:

- It is designed to completely maximize warehouse storage capacity.
- It is a high storage capacity with unrestricted access to pallets.
- The pallet can be accessed with Turret Truck which is known as VNA Truck.
- VNA Truck operates on floor guided by rails or wire induction and it can lift pallets up to 14 meter high.
- Can save up to 50% more space by using VNA truck compared to standard reach truck.
- reach truck.

ADVANTAGES:

- 100% accessibility to each pallet.
- High visibility on stored goods.
- Similar pallet types are unnecessary.

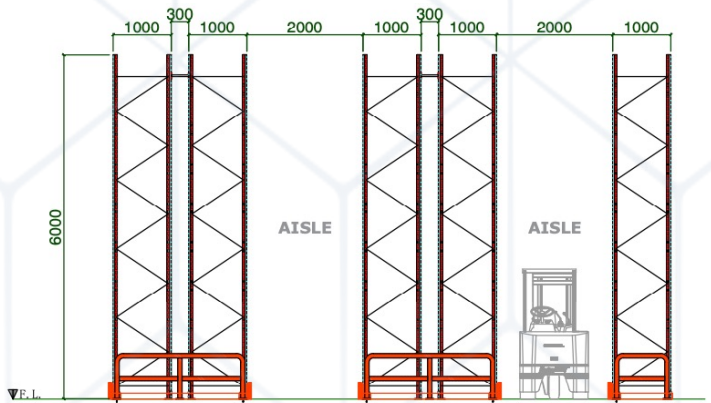
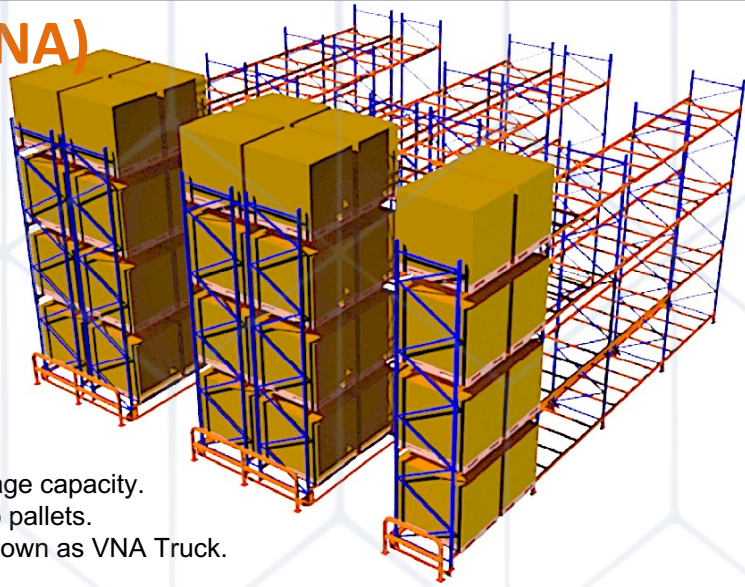

DRIVE – IN RACKING SYSTEM

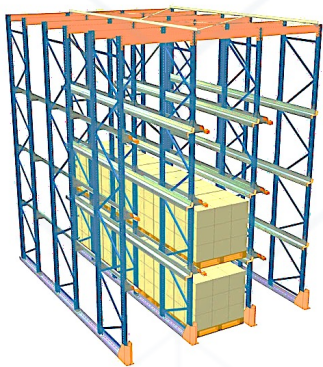

This is the most preferred solution to conventional block stacking where pallets simply cannot be stacked on top of each other. It is effective in optimizing the warehouse storage and thus reducing the number of working aisles. Ideally such storage systems are suitable for storage of homogenous products with no Time or Date sensitive.

FEATURES:

- It is suitable for storing large quantities and small varieties.
- Optimize the warehouse storage by reducing the number of working aisles.
- Product is rotated in Last In First Out (LIFO) operation because of the single entry point.
- Suitable for storage of homogenous products with no time or date sensitive.

ADVANTAGES:

- High storage density.
- Space optimization by eliminating aisles between racks.
- Suitable for a large number of homogenous products.

Sample layout drawing for your reference

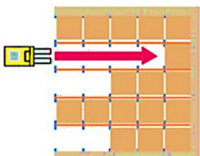
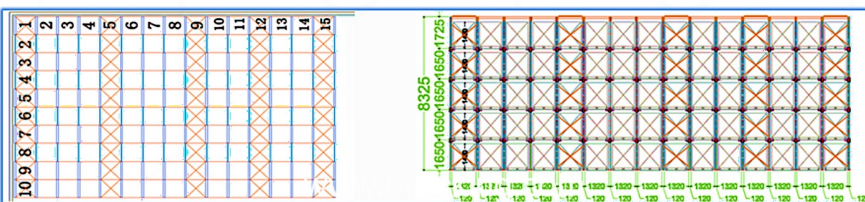

Single Entry Racks:
Forklift can enter the racking only from one side, first in last out

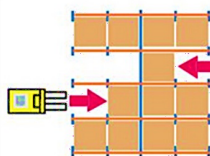

Double entry Rack:
Forklift can enter the rack from both side, there is middle beam in middle position to increase stability

RADIO SHUTTLE RACKING SYSTEM



Shuttle Rack System is considered as an improvisation of conventional Drive-In Rack System. The main difference with Drive-In System is the storing and retrieving of pallets in and out of the racks was via a semi-automated shuttle cart. Similarly as Drive-In, Shuttle Racking System are very suitable for storage of batch quantities for homogeneous product.

FEATURES:

- Improvisation from conventional Drive-In Rack System.
- It is designed for the use of a shuttle machine.
- Carry loading and unloading tasks optimally and at a faster speed.
- Automatic and manual operations controlled by a remote using Wi-Fi network.
- Semi-automated and high density storage solution for the handling goods inside the channel.

ADVANTAGES:

- Smart control of inventory due to sensors installed in the shuttle which enables to identify the empty space in storage shelves.
- Minimizing the risks of accidents and damage within the channel.
- It can operate in cold temperatures as low as -25 °C to 0 °C and as well as at ambient temperature.

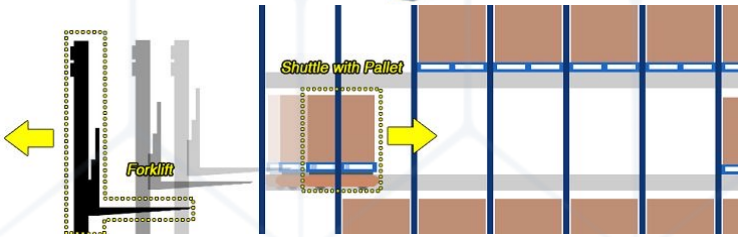

AUTOMATED STORAGE AND RETRIEVAL (AS/RS) SYSTEM

For Automated Storage and Retrieval System (AS/RS) are storage solutions using stacker cranes or other similar automated mechanisms for placing and retrieving loads from a defined storage location.

FEATURES:

- A computer and robot aided system that can retrieve items or store them in specific locations in the warehouse.
- Consists of shuttles, cranes, carousels, vertical lift modules (VLM) and other systems.

ADVANTAGES:

- Improved accuracy, efficiency and productivity.
- Minimal handling time thus make it very suitable for operations with high throughput.
- Extremely high inventory storage density solutions due to

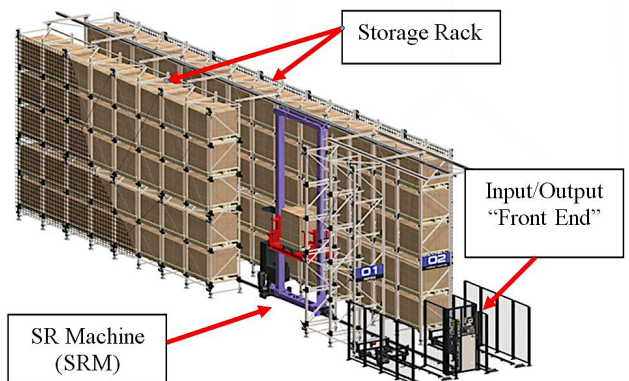

PALLET FLOW RACKING SYSTEM



A pallet flow racking system is a warehouse storage solution that utilizes inclined roller tracks to allow for seamless movement and quick retrieval of pallets. By utilizing gravity, this system promotes efficient inventory rotation and is ideal for high-density storage of perishable goods or time-sensitive inventory. It can be operate with both FIFO and LIFO system to maximizes productivity while reducing labor costs for inventory management.

FEATURES:

- Works in exactly the same way as carton live storage except on a much bigger scale.
- Combination of elevated rails and dynamic components (wheels, rollers) within the structure.
- Can operate with Last in First Out (LIFO) and First In First Out (FIFO).
- Flow created by loading action and gravity with no extra energy consumptions.
- Any size and shape of pallet can be handled.

•ADVANTAGES:

- Reduced damaged goods since no forklift can enter the system.
- Minimal maintenance and reliable.
- No energy consumption because the flow created by loading action and the gravity.

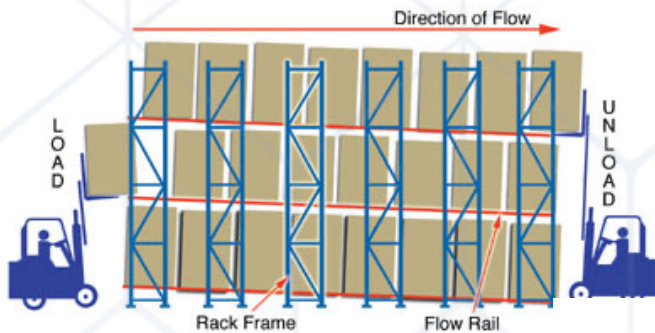

CART PUSH BACK RACKING SYSTEM

The cart push back racking system is a dynamic storage solution designed to optimize space utilization in warehouses. This system allows carts to be pushed back on a nesting cart along inclined rails, providing high-density storage for palletized goods. With its gravity-based design, products are easily accessible, facilitating efficient stock rotation. It maximizes storage capacity as it have 2 to 4 deeps of storage making it an ideal solution for businesses looking to increase storage capacity.

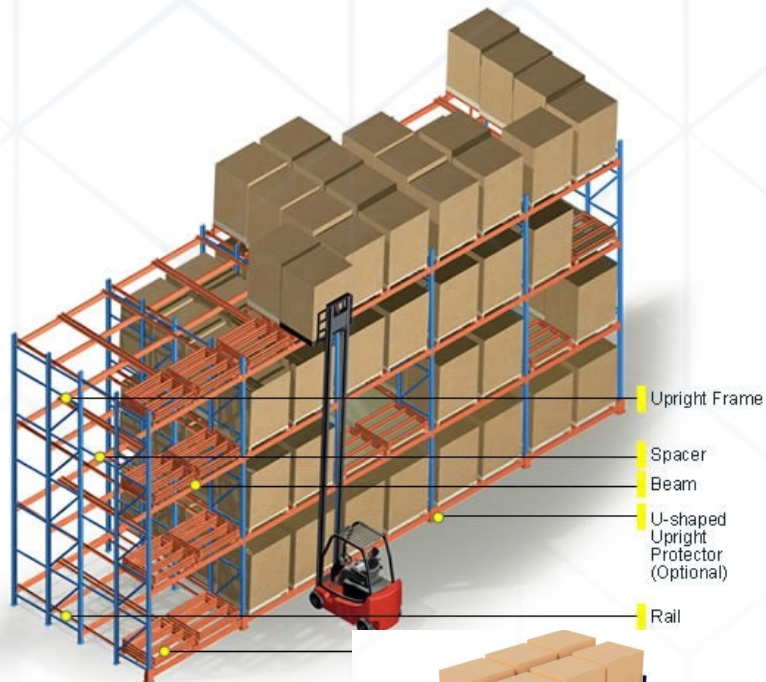

FEATURES:

- Accessible by Last In First Out (LIFO) operation.
- Fully operational in freezers and coolers.
- Allows pallets to be stored from 2 to 4 deeps on either side of an aisle.
- Contains a pair of inclined rails and a series of nesting carts which rides on these rails.

•ADVANTAGES:

- Reduce the time during unloading process.
- Shorten loading and unloading time of the pallet since forklift travelling distance is reduced.
- Higher storage density than other form of racking.



MULTI-TIER RACKING SYSTEM

Multi-Tier Racking System (MTR) is a mezzanine that is design and built via the pallet racking or shelving system. It can be the most efficient and economical method to create extra floor space within the building area compounds. Depending on the load design and requirements, a MTR System height can be maximized up to building's ceiling height.

FEATURES:

- A mezzanine that is design and built via pallet racking or shelving system.
- Various levels can be easily accessed by stairs.
- It can be maximized up to building's ceiling height.

•ADVANTAGES:

- Ensure maximum utilization of space at height.
- Suitable for order picking and archive storage.
- High accessibility to product.

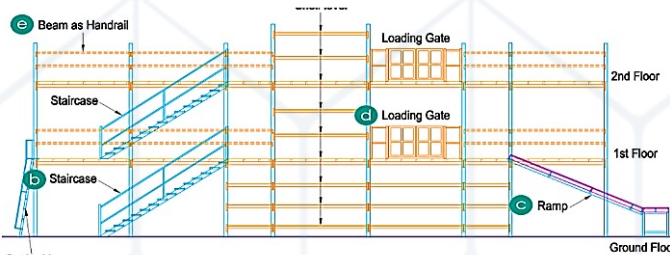
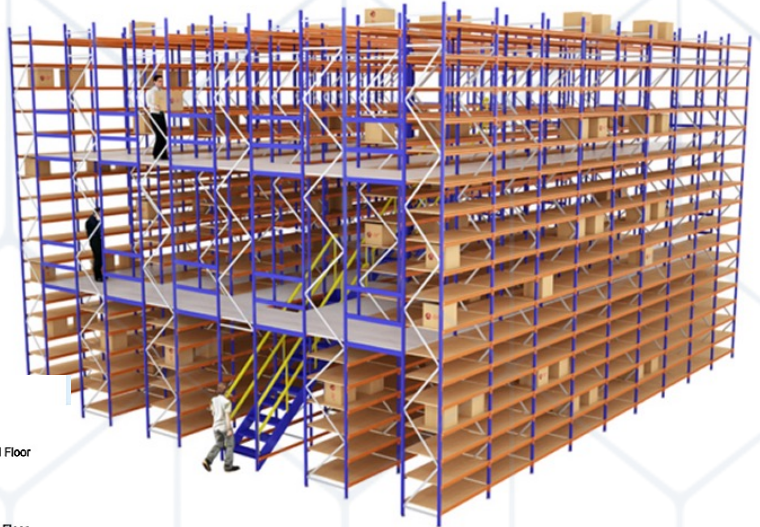

LONGSPAN SHELVING SYSTEM

Longspan Shelving System are designed for medium-duty warehouse applications yet in a not bulky appearance. With profile design & capabilities that proves to be stronger than Boltless Shelving System and almost similar as Pallet Racking System, the system can either be used as Storage Rack or Mezzanine System.

FEATURES:

- The Longspan Shelving is an alternative storage system to Pallet Racking.
- The overall design and set-up is similar to pallet racking but has smaller dimensions and lesser weight load capacity.
- It is suitable for the storage of medium duty goods with weight not more
- Capacity have **1000kgs. / 500 kgs / 300 kgs / 200 kgs**
- Suitable for industries/businesses with characteristic which are
- hand-loaded storage, medium duty storage and storage and display equipment.

•ADVANTAGES:

- Save on storage space since it is a multi-tier shelves.
- Flexibility and adjustable height.
- Compatible with other equipment such as wooden walkways,
- perforated steel and etc.

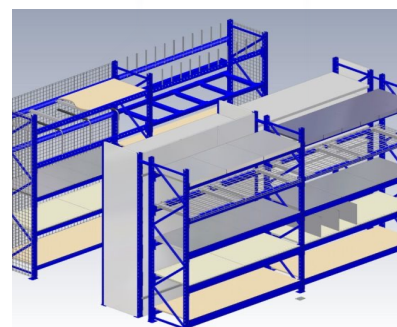

CARTON FLOW RACKING SYSTEM

A carton flow system is designed to maximize efficiency and accessibility in warehouses. It consists of inclined rollers or rails that allow products to move smoothly via gravity when one product is removed, making it ideal for high-volume and fast-paced environments.

FEATURES:

- Accessible by First In First Out (FIFO) principles.
- Manual handling.
- Inserting goods into the back of the structure and removing them from the front.

ADVANTAGES:

- Minimize stock selection errors by giving each product dedicated lane.
- Excellent storage density.
- Easy access to the product.

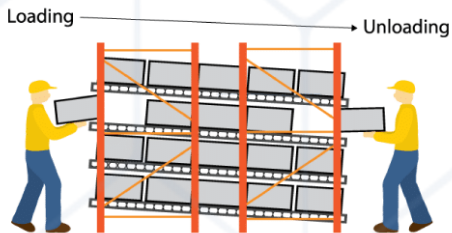

BOLTLESS SHELVING SYSTEM

For light-duty storage, range LESS THAN 100Kgs/Level, boltless shelving system would be the recommended system. Using bolt free connection, this shelving system are easy to install and versatile. It can be easily customize, mix & match as per user's individual requirement.

FEATURES:

- It is for light duty storage ranging less than 400kg/level.
- Preferred storage solution for office, manufacturing, retail and distribution industries.

ADVANTAGES:

- Easy to install since it is a bolt free connection.
- Easy to customize as per customer requirement.
- Access to all sides since there is no sway or cross braces.



More "Key-Holes"
= More Levels



Reinforced Design (APH & DRI)



C-Type Beam (DRB)



CANTILEVER RACKING SYSTEM

For storage and retrieval of long items, it is best to use Cantilever Racking System. It is designed to manage loads of varying length and proportion; to be completely accessible from the front without any horizontal restrictions like the conventional pallet racking system.

FEATURES:

- Highly customizable and allows easy access to products regardless of their shape and size.
- It is designed to manage loads of varying length and proportion.
- Easily accessible from the fronts.
- Cost effective option that is ideal for storing item an material that is
- long, bulky or irregular shape e.g. steel pipes, woode planks and etc.

ADVANTAGES:

- Easy to install and reconfigure.
- Increase vertical storage capacity.
- Accommodates high capacity requirement.

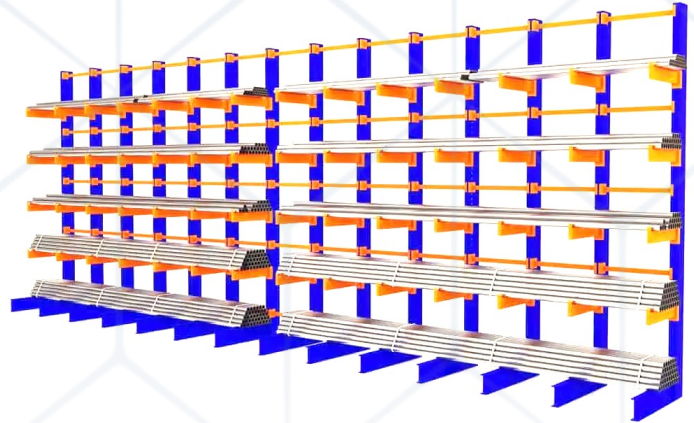

GONDOLA SHELVING



UPRIGHT can innovative product design, standardized production, high quality service as the core of the three major advantages, for each customer to provide the perfect store image design and solution, make the products more standard and efficient. We provide product samples, and accepts product customization, meet your requirements as much as possible.

Our Service

- The backboard of the shelf can be punched or not punched
- The color of the price tag can be customized
- The Angle of the shelves can be adjusted
- Additional shelves can be added
- Cabinets and drawers can be added at the bottom
- Advertisements or light boxes can be hung to the top
- Customize extra accessories

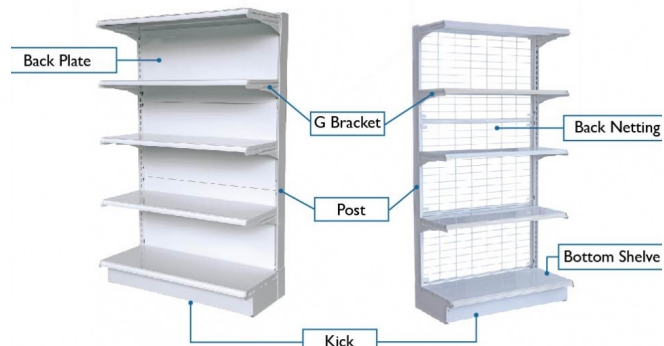

STRUCTURAL STEEL PLATFORM



Structural Steel Platform (SSP) is a mezzanine but it was built via long steel items, e.g. I-Beam, RSC Beam, Hollow Section and etc. Similarly as MTR, based on requirement, there is various type of Floor Decking Type & Accessories could add to the design of SSP.

FEATURES:

- Designed and manufactured based on site requirement, functional requirement and logistic requirement.
- Made with heavy, low gauge steel components that are assembled by bolting them together.
- Suitable for manual picking good for second layer shelves.

ADVANTAGES:

- Storage space utilization with minimal overhead cost.
- Keep the flow plan from undergoing expensive structural changes.
- Customizable to floor loading as high as 1000kgs/m2.



MEZZANINE PLUS SYSTEM

Mezzanine Plus System is UPRIGHT latest improvised Structural Steel Platform system that performing the same as a Free- Standing Industrial Platform yet with a built-in Modular System concept. It come with "Hook On & Hook Off" concept which makes it easy to install & uninstall, relocate and reused. It can be easily assembled on-site without the need for welding, cutting, or painting.

FEATURES:

1. Column Details

The columns come with 100mm pitch that allows flexibility in adjusting the mezzanine height.

2. Beams_C-Purlin Details

Manufactured with pre-selected high tensile materials and it is available in Floor Load Capacity as high as 500kgs/m2.

3. Flooring Materials

Available in 3 flooring materials options for end user to choose from.

4. { Plywood

{ Interlock Perforated Panel { Mesh Grating

ADVANTAGES:

- Cost savings and reusable.
- Hassle free during assembled & unassembled process.
- Modular and can be extended or shortened.
- Durable finishing as it finishing is powder-coated.

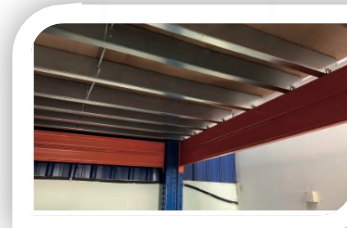

Upright and Frame Protector Accessories

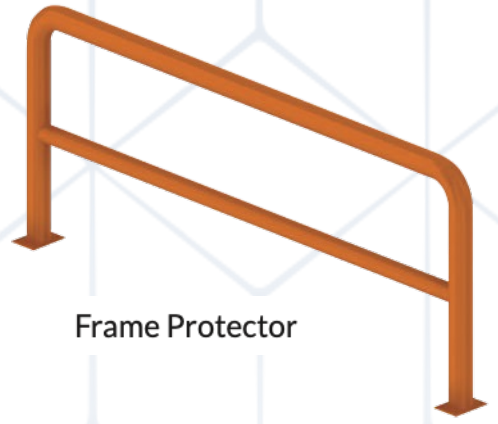

Frame Protector



Corner Protector

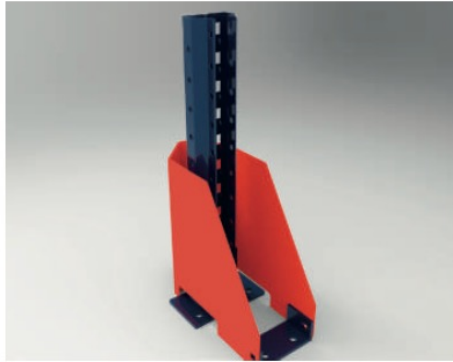

Column Guard



Floor Channel Guide with Bull Nose

Pallet and Shelves Decking Support Accessories

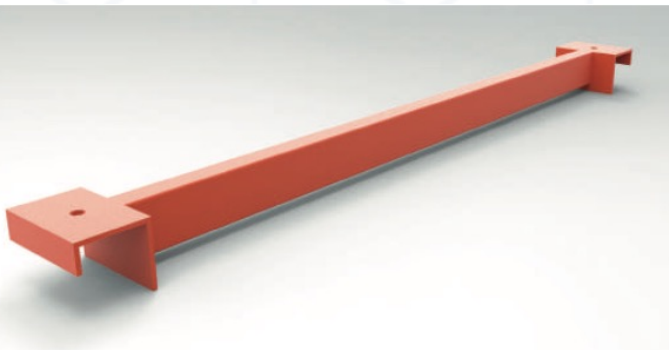

Pallet Support Bar

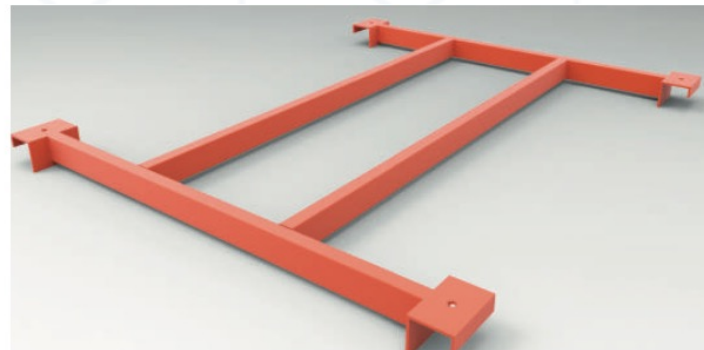

H-Type Pallet Support Bar

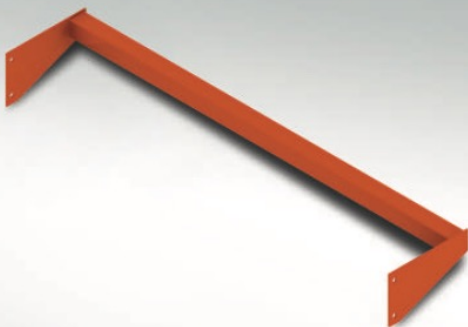

Pallet Back Stopper

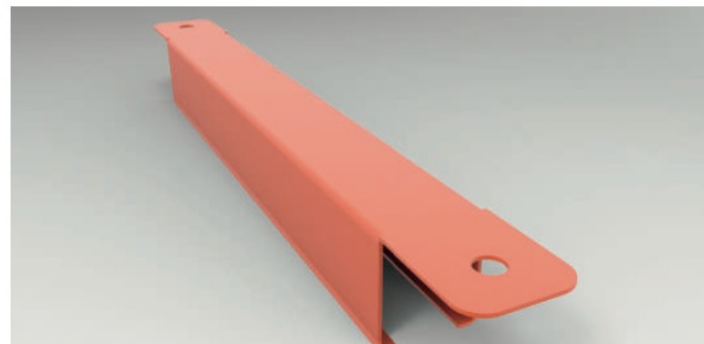

Center Support

Some of Accomplished Projects

 **Shopee**



 **Schneider Electric**



 **MEYCAUAYAN SUKIMART**



 **Yakult**



 **BW MANUFACTURING**



 **brother**



 **Mondelēz International**



 **ASD PIPEPLAST SUPPLY**



Siix
We care



Uratex
FOAM



GEELY AUTO



NEP LOGISTICS, INC.



Some of our Clients

Mondelēz
International

ENTREGO
EXPRESS CORPORATION

NEX
NIPPON
EXPRESS

OOCL
Logistics

POWERMARK

HANKYU HANSHIN
EXPRESS

GEELY AUTO

YAMAHA

Yakult

DSV

Schneider
Electric

GLACIER SOUTH
REGISTRATION SERVICES CORP.

Uratex
FOAM

TERUMO **NEP LOGISTICS, INC.**

Rebisco
SINCE 1963

First Philec

RC
cola

Q-TRADE
CORPORATION
EST. 1999
An Affiliate of Quest Technology Singapore Pte. Ltd.

Siix
We care

ROBERTS
Automotive and Industrial Parts Mfg. Corp.

First Philec

SAMSUNG

ROYAL CABLE

mybrush

PARAMETRIC
Engineering and Construction

Uni-President

JOTUN
DECORATION

M&K

GROSS LOGISTICS INC
"Bank of Fusion Logistics Partner"

Magnolia

BW
MANUFACTURING

Shopee brother

SAN MIGUEL
FOODS

CHG
GLOBAL INC.

We firmly believe that only the best team can offer the best service to our customers which leads UPRIGHT to a **BRIGHTER FUTURE**.

Our dream is to make **UPRIGHT** an international well-known brand and exporting our products to every corner of the world

Connect with us.

www.uprightstoragesolutions.com





We're here for you, 24/7.

UPRIGHT STORAGE SOLUTIONS, PH INC.

SCRUPULOUS THINKING

Birmingham Barangay Pulo, City of Cabuyao Laguna, Philippines , 4025

 **Contact us at**
(049)537-9537, (0917)307-4238, (0917)135-6946 , (0917)712-5356
(0917)115-9581 , (0960)911-1879

 **Mail us at**
urssphi@gmail.com , sales1.uprightstorage@gmail.com ,
sales3.uprightstorage@gmail.com , inquiryuprightstorage@gmail.com
jeran.uprightstorage@gmail.com , kate.uprightstorage@gmail.com
eboy.uprightstorage@gmail.com

 **Chat with us at**
www.uprightstoragesolutions.com

 www.facebook.com/UprightStorage/

 **View with us at**
Upright Storage Solutions, Ph